



INTAKE SYSTEMS FOR VEHICLES LISTED ARE 50 STATE LEGAL. SEE KNFILTERS.COM FOR CARB STATUS ON EACH PART FOR A SPECIFIC VEHICLE.

# INSTALLATION INSTRUCTIONS

**57-3111**  
**CHEVROLET**  
**2019 Corvette ZR1**  
**V8-6.2L Supercharged**

**TOOLS NEEDED:**

- ratchet extension
- 10mm socket
- t20 torx
- 10mm wrench
- phillips screw driver
- flat blade screw driver
- 4mm allen key
- pliers

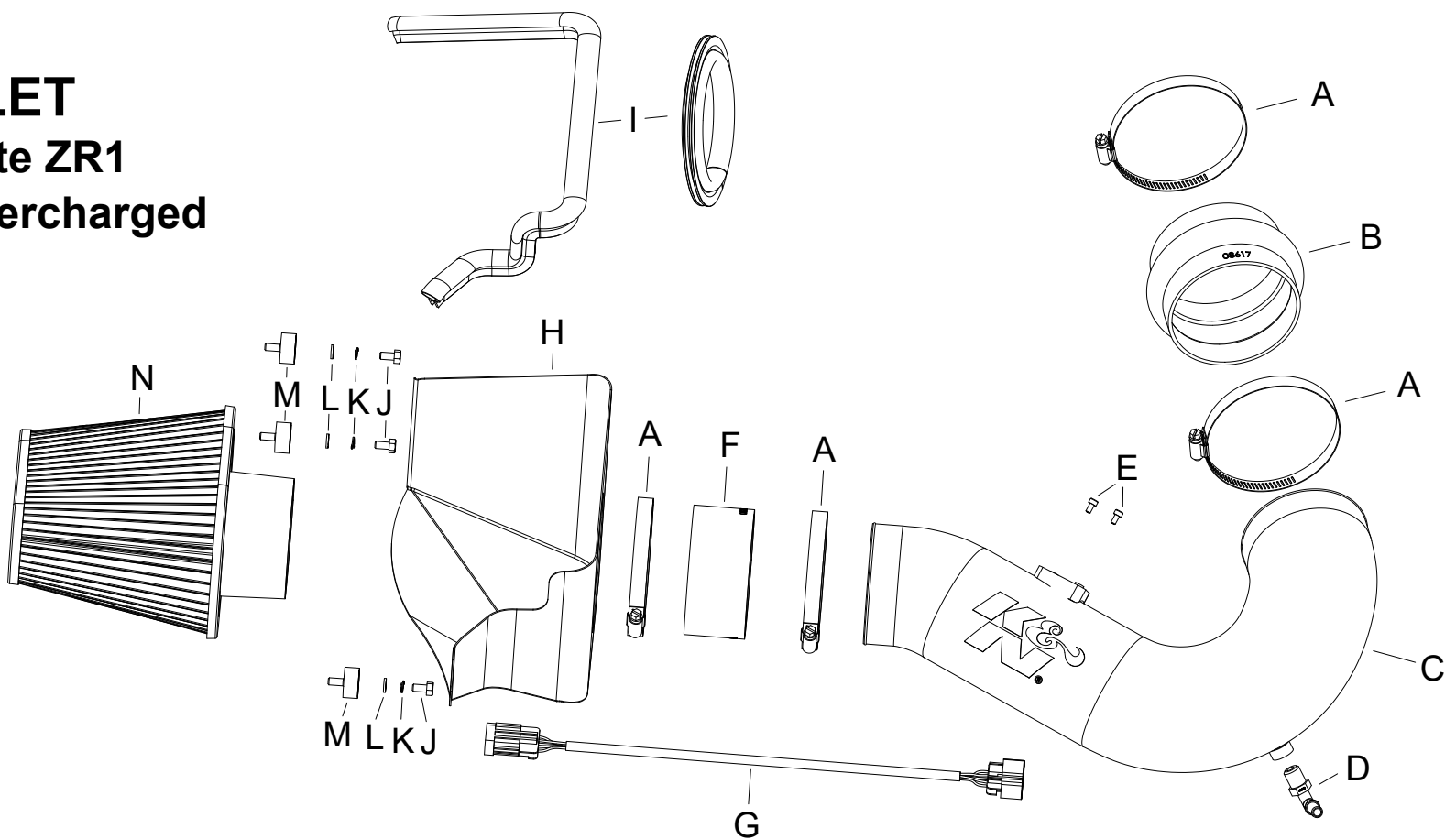

**PARTS LIST:**

Description	Qty.	Part #	Description	Qty.	Part #	Description	Qty.	Part #
A HOSE CLAMP #64, BLACK ZINC	4	08645KA	F HOSE; 4"ID X 2"L REINFORCED	1	08761	K WASHER, M6 SPLIT LOCK ZINC	3	1-3025
B HOSE; HUMP 4"ID TO 4.19"ID	1	08633	G MAF EXTENSION HARNESS	1	21786	L WASHER; 6MM FLAT	3	08269
C TUBE; MO, CARBON	1	087431	H HEAT SHIELD; CARBON FIBER	1	073286	M STUD; RUBBER MNT, M/F, 1/2"L	3	070228
D VENT; 90°, 1/4NPT TO .375"	1	82632	I EDGE TRIM (35")	1	102471A	N AIR FILTER	1	RP-5285
E BOLT; M4 - .7 X 8MM, A/H CAP	2	07733	J BOLT; M6 X 1 X 12MM, HEX	3	07727			

**If you need any assistance please call 1-800-858-3333 to speak with a representative in our Customer Service Center before returning the product.**

**NOTE: FAILURE TO FOLLOW INSTALLATION INSTRUCTIONS AND NOT USING THE PROVIDED HARDWARE MAY DAMAGE THE INTAKE TUBE, THROTTLE BODY AND ENGINE.**

**TO START:**

1. Turn off the ignition and disconnect the negative battery cable.  
**NOTE: Disconnecting the negative battery cable erases pre-programmed electronic memories. Write down all memory settings before disconnecting the negative battery cable. Some radios will require an anti-theft code to be entered after the battery is reconnected. The anti-theft code is typically supplied with your owner's manual. In the event your vehicles anti-theft code cannot be recovered, contact an authorized dealership to obtain your vehicles anti-theft code.**



2. Loosen the four bolts that secure the supercharger cover, remove the bolts and then remove the cover from the vehicle.



3. Loosen the four bolts that secure the air extractor duct to the radiator and then remove the extractor from the vehicle.



4. Release the locking tab and then disconnect the crank case vent line from the factory intake tube.



5. Loosen the two hose clamps that secure the factory intake tube and then remove the intake tube from the vehicle.



6. Pull the red locking tab back and then disconnect the mass air sensor electrical connection.



7. Loosen the two screws that secure the mass air sensor housing to the air filter housing and then remove the mass air sensor housing from the vehicle.



8. Remove the two bolts that secure the air filter housing to the inner fender and then remove the housing and air filter from the vehicle.

**NOTE: K&N Engineering, Inc., recommends that customers do not discard factory air intake.**



9. Remove the air filter housing mounting stud from the inner fender.



10. Install the three rubber mounted studs into the air filter housing mounting location as shown.



11. Cut the provided edge trim into two sections, one section will be 21" long and the other will be 14" long.



12. Install the edge trim onto the K&N® heat shield as shown.



13. Install the K&N® air filter into the heat shield, install coupler hose (08761) onto the filter and secure with the provided hose clamp.



14. Install the heat shield/air filter assembly onto the rubber mounted studs and secure with the provided hardware.



15. Install the provided coupler (08633) onto the throttle body and secure with the provided hose clamp.

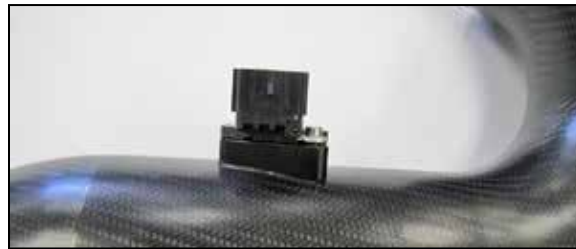

16. Remove the mass air sensor from the factory mass air sensor housing and install it into the K&N® intake tube using the provided hardware.



17. Install the provided crank case quick connect fitting into the K&N® intake tube as shown.

**NOTE: Plastic NPT fittings are easy to cross thread. Install the vent fitting "hand" tight, then turn it two complete turns with a wrench.**



18. Install the K&N® intake tube into the coupler hose at the air filter and then into the coupler at the throttle body. Adjust the tube for best fit and then secure with the provided hose clamps.



19. Connect the factory crank case vent line to the quick connect fitting installed into the K&N® intake tube.



20. Using the provided extension harness, reconnect the mass air sensor electrical connection.

**NOTE: Be sure to route the harness away from the engine pulleys and belts.**



21. Reinstall the air extractor duct and secure with the factory hardware.



22. Reinstall the super charger cover and secure with the factory hardware.

23. The C.A.R.B. exemption sticker, (attached), must be visible under the hood so that an emissions inspector can see it when the vehicle is required to be tested for emissions. California requires testing every two years, other states may vary.

24. Reconnect the vehicle's negative battery cable. Double check to make sure everything is tight and properly positioned before starting the vehicle.

25. It will be necessary for all K&N® high flow intake systems to be checked periodically for realignment, clearance and tightening of all connections. Failure to follow the above instructions or proper maintenance may void warranty.

#### ROAD TESTING:

1. Start the engine with the transmission in neutral or park, and the parking brake engaged. Listen for air leaks or odd noises. For air leaks secure hoses and connections. For odd noises, find cause and repair before proceeding. This kit will function identically to the factory system except for being louder and much more responsive.

2. Test drive the vehicle. Listen for odd noises or rattles and fix as necessary.

3. If road test is fine, you can now enjoy the added power and performance from your kit.

4. K&N Engineering, Inc., requires cleaning the intake system's air filter element every 100,000 miles. When used in dusty or off-road environments, our filters will require cleaning more often. We recommend that you visually inspect your filter once every 25,000 miles to determine if the screen is still visible. When the screen is no longer visible some place on the filter element, it is time to clean it. To clean and re-oil, purchase our filter Recharger® service kit, part number 99-5050 or 99-5000 and follow the easy instructions.

**INTAKE SYSTEMS FOR VEHICLES LISTED ARE 50 STATE LEGAL. SEE KNFILTERS.COM FOR CARB STATUS ON EACH PART FOR A SPECIFIC VEHICLE.**